

Straight Flanged Thermowell

Straight Flanged Thermowells are used in process pipe line, tanks or reactors (due to they are to be removed for inspection) . ATC Control manufactures it for petrol applications when high rigidity and material frequency recommends it.

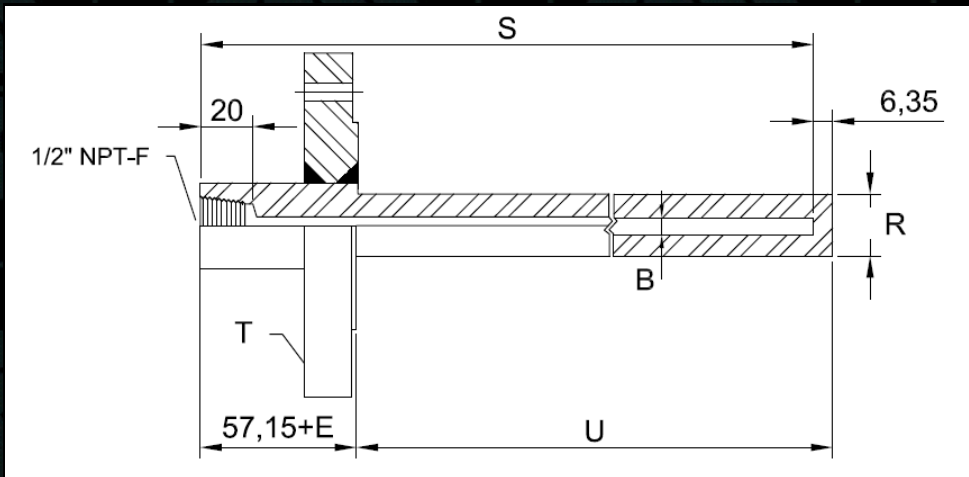

Please fill in the required information:

Thermowell Dimensions

Id	"F"	"R"	"R" mm
A	1"	7/8"	22,22
B	1 1/2"	1"	25,40
C	2"	1 1/16"	26,98
X	Other please specify		

Fluid: Classified Area (Y/N):
 Specific Weight: s.w. Viscosity: cp
 Pipe Size: mm Schedule: mm
 Pressure: Min. bar Work bar Max. bar
 Flow: Min. l/s Work l/s Max. l/s
 Temperature: Min. °C Work °C Max. °C

Ref: SFT- D ell 0164,80 0020,00 0087,65 FF 1 A 023 HT, FP 005, 009

"B" Well Bore (mm)

- 1 6,604 for 6,350 OD Elements
- 2 6,254 for 6,000 OD Elements
- X Other, please specify

"S" Stem Length

Please Specify stem length in millimeters:
 For example: 164,80mm

"E" Lag Extension

Please Specify lag extension in millimeters:
 For example: 20mm

"U" Insertion Length

Please Specify insertion length in millimeters:
 For example: 87,65mm

Flange Type

- RF Raised Face R.F. - C
- FF Flat Face F.F. - O
- RTJ Ring Type Joint R.T.J. - F/N

Options

Please Specify 2 digits code as located in options table (pag 17)

HT, FP (i.e.: HT, FP)
 HT Hydrostatic Test
 FP Full Penetration Welding

Documentation

Please Specify 3 digits code as located in doc. table (pag 18)

005, 009 (i.e.: 005, 009)
 005 Stress Calculation
 009 Material Certificate EN 10204-3.1

023 Well Material

Please Specify 3 digits code as located in Material table (pag 19), example:

023 321-SS

"T" Flange size (SLIP ON TYPE)

DIN		ANSI	
A	DN25	C	1"
B	DN40	D	1 1/2"
X	Other, please specify		

"T" Rating

ANSI		DIN	
1	150#	7	PN16
2	300#	8	PN25
3	600#	9	PN40
4	900#	10	PN65
5	1500#	11	PN100
6	2500#	12	PN160

* Thermowells are made from round bar with milled wrench flats

Please specify here your X or XX selected:

Straight Flanged Thermowell

Straight Flanged Thermowells are used in process pipe line, tanks or reactors (due to they are to be removed for inspection) . ATC Control manufactures it for petrol applications when high rigidity and material frequency recommends it.

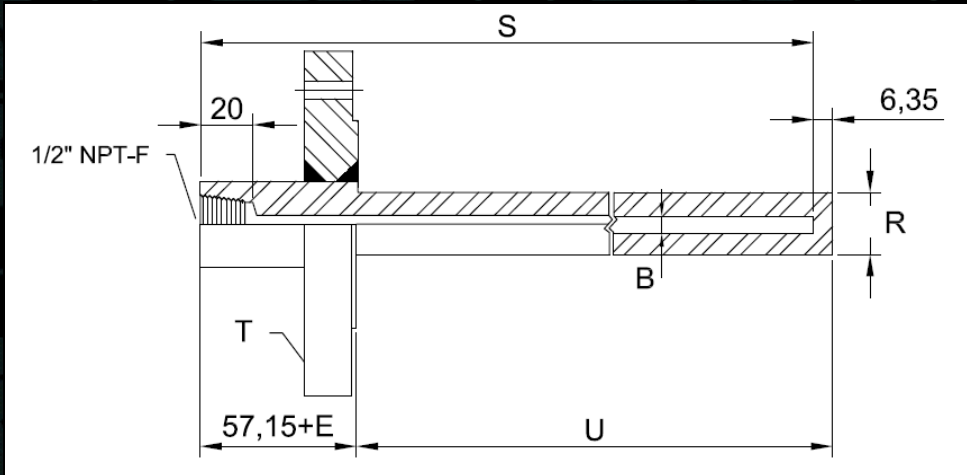

Please fill in the required information:

Fluid: Classified Area (Y/N):

Specific Weight: s.w. Viscosity: cp

Pipe Size: mm Schedule: mm

Pressure: Min. bar Work bar Max. bar

Flow: Min. l/s Work l/s Max. l/s

Temperature: Min. °C Work °C Max. °C

Thermowell Dimensions

Id	"F"	"R"	"R" mm
A	1"	7/8"	22,22
B	1 1/2"	1"	25,40
C	2"	1 1/16"	26,98
X	Other please specify		

Ref: SFT-

"B" Well Bore (mm)

- 1 6,604 for 6,350 OD Elements
- 2 6,254 for 6,000 OD Elements
- X Other, please specify

"S" Stem Length

Please Specify stem length in millimeters:

For example: 164,80mm

"E" Lag Extension

Please Specify lag extension in millimeters:

For example: 20mm

"U" Insertion Length

Please Specify insertion length in millimeters:

For example: 87,65mm

Flange Type

- RF Raised Face R.F. - C
- FF Flat Face F.F. - O
- RTJ Ring Type Joint R.T.J. - F/N

Options

Please Specify 2 digits code as located in options table (pag 17)

- (i.e.: HT, FP)
- HT Hydrostatic Test
- FP Full Penetration Welding

Documentation

Please Specify 3 digits code as located in doc. table (pag 18)

- (i.e.: 005, 009)
- 005 Stress Calculation
- 009 Material Certificate EN 10204-3.1

Well Material

Please Specify 3 digits code as located in Material table (pag 19), example:

- 023 321-SS

"T" Flange size (SLIP ON TYPE)

DIN		ANSI	
A	DN25	C	1"
B	DN40	D	1 1/2"
X	Other, please specify		

"T" Rating

ANSI		DIN	
1	150#	7	PN16
2	300#	8	PN25
3	600#	9	PN40
4	900#	10	PN65
5	1500#	11	PN100
6	2500#	12	PN160

* Thermowells are made from round bar with milled wrench flats

Please specify here your X or XX selected: