

Nozzles Flanged Set

Nozzles are used to determine a fluid's flowrate through a pipe. Higher coefficient of discharge and efficient than other flow meters of the same size. ACT-CONTROL manufactures with regard to customer requirement from 1" and above nozzles used for high-velocity, temperature and pressure applications indicated for corrosive flow media. Used for clean and non-viscous media as steam, water, air or gas with standard accuracy.

Please fill in the required information:

Fluid: Classified Area (Y/N):

Specific Weight: s.w. Viscosity: cp

Outside Diameter/Pipe Size: mm/inch

Thickness/Schedule: mm/inch

Pressure: Min. bar Work bar Max. bar

Flow: Min. l/s Work l/s Max. l/s

Temperature: Min. °C Work °C Max. °C

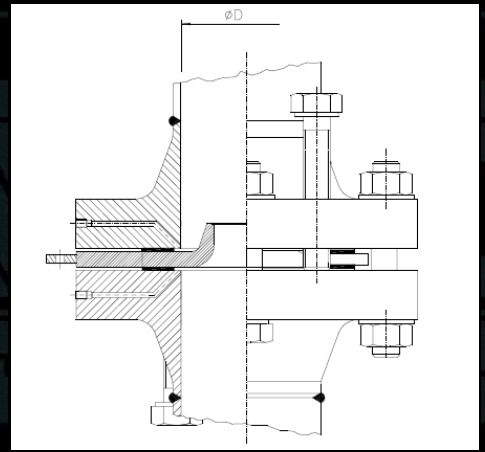

Nozzle Type

- A Long Radius Low Beta (D, D/2 taps)
- B Long Radius High Beta (D, D/2 taps)
- C ISA 1932 (Coner Taps)

Ref: NFS- A 1 S 8 PT ES F 030 M W A RTJ - F/N F11 A,H,J HT, DY

Bore Calculation

- A ASME MFC-3M
- B BS 1042
- C ISO 5167

Nozzle Material

- S A182 F316L
- X Other, please specify

Taps Qty and Orientation

- 4 180° - 4 Taps
- 6 90° - 6 Taps
- 8 45° - 8 Taps
- X Other, Please Specify

Taps Type

- FT Flange Taps
- CT Corner Taps
- PT Pipe Taps (D&D/2)

Tapping connection

- DS 1/2" SW
- ES 3/4" SW
- DN 1/2" NPT-F
- EN 3/4" NPT-F
- EP 1/2" NPT-M Pipe
- DP 1/2" NPT-F Pipe
- XX Other, please specify

Flange Size

ANSI		DIN	
A	3"	DN 65	N
B	4"	DN 100	O
C	6"	DN 150	P
D	8"	DN 200	Q
E	10"	DN 250	R
F	12"	DN 300	S
G	14"	DN 350	T
H	16"	DN 400	U
I	18"	DN 450	V
J	20"	DN 500	W
K	22"	DN 550	Z
L	24"	DN 600	AA
X	Other, please specify		

Flange Schedule

010	10
10S	10S
020	20
030	30
STD	STD
40S	40S
040	40
060	60
0XS	XS
80S	80S
080	80
XX	Other, Please Specify
XD	If DIN please specify thickness in mm

Gaskets

- M Metallic
- S Spirometallic
- P Metal-Plastic
- K Klinger - Sil ®
- X Other, please specify

Options

Please Specify 2 characters code as located in options table (pag 12)

HT, DY For example: HT, DY

- HT Hydrostatic Test
- DY Dye Penetrants Test

Documentation

Please Specify 1 character code as located in doc. table (pag 13)

A,H,J For example: A, D, J

- A Calculation data sheet
- H Balance Chamber
- J Material Certificate EN 10204-3.1

Flanges Material

- A05 A-105
- F05 A-182 F5
- F09 A-182 F9
- F11 A-182 F11
- F22 A-182 F22
- F91 A-182 F91
- 304 A-182 F304/L
- 316 A-182 F316/L
- 904 A-182 F904L
- HAS Hastelloy
- MON Monel
- TIT Titanium
- XX Other, Please Specify

Flange Facing

- RF - C Raised Face RF
- RTJ - F/N Ring Type Joint RTJ
- FF - O Flat Face
- XX Other, please specify

Flange Rating

ANSI		DIN	
A	150#	G	PN 16
B	300#	H	PN 25
C	600#	I	PN 40
D	900#	J	PN 64
E	1500#	K	PN 100
F	2500#	L	PN 250
X	Other, please specify		

Flange Type

- W Welding Neck
- S Socket Welding
- X Other, please specify

Please specify here your X or XX selected:

Nozzles Flanged Set

Nozzles are used to determine a fluid's flowrate through a pipe. Higher coefficient of discharge and efficient than other flow meters of the same size. ACT-CONTROL manufactures with regard to customer requirement from 1" and above nozzles used for high-velocity, temperature and pressure applications indicated for corrosive flow media. Used for clean and non-viscous media as steam, water, air or gas with standard accuracy.

Please fill in the required information:

Fluid: Classified Area (Y/N):

Specific Weight: s.w. Viscosity: cp

Outside Diameter/Pipe Size: mm/inch

Thickness/Schedule: mm/inch

Pressure: Min. bar Work bar Max. bar

Flow: Min. l/s Work l/s Max. l/s

Temperature: Min. °C Work °C Max. °C

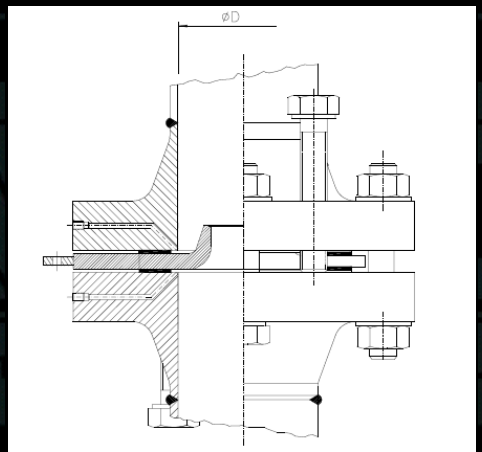

Nozzle Type

- A Long Radius Low Beta (D, D/2 taps)
- B Long Radius High Beta(D, D/2 taps)
- C ISA 1932 (Coner Taps)

Ref: NFS-

Bore Calculation

- A ASME MFC-3M
- B BS 1042
- C ISO 5167

Nozzle Material

- S A182 F316L
- X Other, please specify

Taps Qty and Orientation

- 4 180° - 4 Taps
- 6 90° - 6 Taps
- 8 45° - 8 Taps
- X Other, Please Specify

Taps Type

- FT Flange Taps
- CT Corner Taps
- PT Pipe Taps (D&D/2)

Tapping connection

- DS 1/2" SW
- ES 3/4" SW
- DN 1/2" NPT-F
- EN 3/4" NPT-F
- EP 1/2" NPT-M Pipe
- DP 1/2" NPT-F Pipe
- XX Other, please specify

Flange Size

ANSI		DIN	
A	3"	DN 65	N
B	4"	DN 100	O
C	6"	DN 150	P
D	8"	DN 200	Q
E	10"	DN 250	R
F	12"	DN 300	S
G	14"	DN 350	T
H	16"	DN 400	U
I	18"	DN 450	V
J	20"	DN 500	W
K	22"	DN 550	Z
L	24"	DN 600	AA
X	Other, please specify		

Flange Schedule

010	10
10S	10S
020	20
030	30
STD	STD
40S	40S
040	40
060	60
0XS	XS
80S	80S
080	80
XX	Other, Please Specify
XD	If DIN please specify thickness in mm

Gaskets

- M Metallic
- S Spirometallic
- P Metal-Plastic
- K Klinger - Sil ®
- X Other, please specify

Options

Please Specify 2 characters code as located in options table (pag 12)

For example: HT, DY

- HT Hydrostatic Test
- DY Dye Penetrants Test

Documentation

Please Specify 1 character code as located in doc. table (pag 13)

For example: A, D, J

- A Calculation data sheet
- H Balance Chamber
- J Material Certificate EN 10204-3.1

Flanges Material

- A05 A-105
- F05 A-182 F5
- F09 A-182 F9
- F11 A-182 F11
- F22 A-182 F22
- F91 A-182 F91
- 304 A-182 F304/L
- 316 A-182 F316/L
- 904 A-182 F904L
- HAS Hastelloy
- MON Monel
- TIT Titanium
- XX Other, Please Specify

Flange Facing

- RF - C Raised Face RF
- RTJ - F/N Ring Type Joint RTJ
- FF - O Flat Face
- XX Other, please specify

Flange Rating

ANSI		DIN	
A	150#	G	PN 16
B	300#	H	PN 25
C	600#	I	PN 40
D	900#	J	PN 64
E	1500#	K	PN 100
F	2500#	L	PN 250
X	Other, please specify		

Flange Type

- W Welding Neck
- S Socket Welding
- X Other, please specify

Please specify here your X or XX selected: