

Chamber and Diaphragms Flowmeter

Primary differential pressure device used for volume and mass flow measurement is suitable for non-corrosive or corrosive gases, vapors and liquids and ATC Control manufactures it according to EN ISO 5167.

Please fill in the required information:

Fluid: Classified Area (Y/N):

Specific Weight: s.w. Viscosity: cp

Outside Diameter/Pipe Size: mm/inch

Thickness/Schedule: mm/inch

Pressure: Min. bar Work bar Max. bar

Flow: Min. l/s Work l/s Max. l/s

Temperature: Min. °C Work °C Max. °C

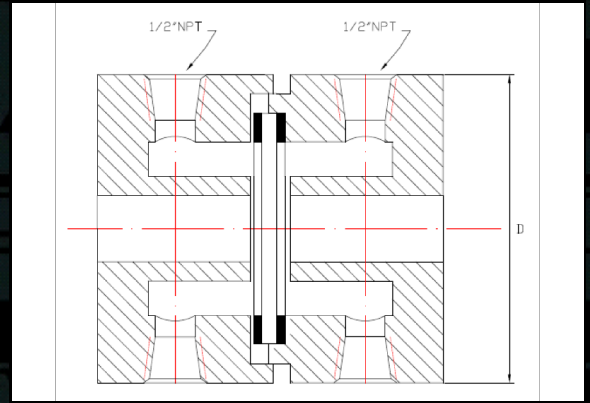

Annular Ring Type

MB	Multiorifice
SE	Square Edge - Clean liquids gases & Steam Reynolds 10.000 to 10.000.000
SG	Segmental - Solids in a gas or liquid flow
EC	Eccentric - Liquids with sediment or vapor with vapor deposit
QE	Quadrant Edge - Reynolds 2.000 to 10.000
CO	Conical - Viscous Fluid Reynolds 80 to 2.000
XX	Other, Please Specify

Ref: CDF- SG 1 S 4 DRF EP P 030 F W A RF - C A05 A,H,J HT, DY

Bore Calculation

A	ASME MFC-3M
B	BS 1042
C	ISO 5167

Annular Ring and Plate Material

S	A182 F316L
X	Other, please specify

Taps Qty and Orientation

4	180° - 4 Taps
X	Other, Please Specify

Taps Type

SRC	Single Ring, Corner Tapping
DRF	Double Ring, Flange Tapping
DRC	Double Ring, Corner Tapping
DAC	Double Ring, Annular Chamber

Tapping connection

DN	1/2" NPT-F
EP	1/2" NPT-M Pipe
DP	1/2" NPT-F Pipe
XX	Other, Please Specify

Gaskets

S	Spirometallic
P	Metal-Plastic
K	Fiber + NBR
X	Other, please specify

Flange Schedule

010	10
10S	10S
020	20
030	30
STD	STD
40S	40S
040	40
060	60
0XS	XS
80S	80S
080	80
XX	Other, Please Specify
XD	If DIN please specify thickness in mm

Flange Size

ANSI		DIN	
B	3"	DN 65	O
C	4"	DN 100	P
D	6"	DN 150	Q
E	8"	DN 200	R
F	10"	DN 250	S
G	12"	DN 300	T
X	Other, Please Specify		

Options

Please Specify 2 characters code as located in options table (pag 12)

HT, DY		For example: HT, DY
HT	Hydrostatic Test	
DY	Dye Penetrants Test	

Documentation

Please Specify 1 character code as located in doc. table (pag 13)

A,H,J		For example: A, D, J
A	Calculation data sheet	
H	Balance Chamber	
J	Material Certificate EN 10204-3.1	

Flanges Material

A05	A-105
F05	A-182 F5
304	A-182 F304/L
316	A-182 F316/L
904	A-182 F904L
HAS	Hastelloy
MON	Monel
TIT	Titanium
XX	Other, Please Specify

Flange Facing

RF - C	Raised Face RF
FF - O	Flat Face
XX	Other, please specify

Flange Rating

ANSI		DIN	
A	150#	G	PN 16
B	300#	H	PN 25
C	600#	I	PN 40
		X	Other, please specify

Flange Type

W	Welding Neck
S	Socket Welding
X	Other, please specify

Please specify here your X or XX selected:

Chamber and Diaphragms Flowmeter

Primary differential pressure device used for volume and mass flow measurement is suitable for non-corrosive or corrosive gases, vapors and liquids and ATC Control manufactures it according to EN ISO 5167.

Please fill in the required information:

Fluid: Classified Area (Y/N):

Specific Weight: s.w. Viscosity: cp

Outside Diameter/Pipe Size: mm/inch

Thickness/Schedule: mm/inch

Pressure: Min. bar Work bar Max. bar

Flow: Min. l/s Work l/s Max. l/s

Temperature: Min. °C Work °C Max. °C

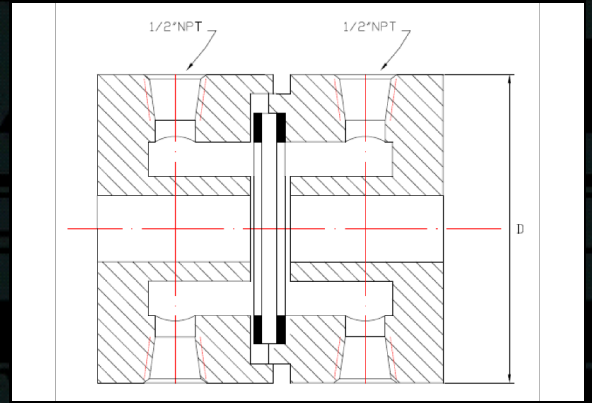

Annular Ring Type

- MB Multiorifice
- SE Square Edge - Clean liquids gases & Steam Reynold 10.000 to 10.000.000
- SG Segmental - Solids in a gas or liquid flow
- EC Eccentric - Liquids with sediment or vapor with vapor deposit
- QE Quadrant Edge - Reynolds 2.000 to 10.000
- CO Conical - Viscous Fluid Reynolds 80 to 2.000
- XX Other, Please Specify

Ref: CDF-

Bore Calculation

- A ASME MFC-3M
- B BS 1042
- C ISO 5167

Annular Ring and Plate Material

- S A182 F316L
- X Other, please specify

Taps Qty and Orientation

- 4 180° - 4 Taps
- X Other, Please Specify

Taps Type

- SRC Single Ring, Corner Tapping
- DRF Double Ring, Flange Tapping
- DRC Double Ring, Corner Tapping
- DAC Double Ring, Annular Chamber

Tapping connection

- DN 1/2" NPT-F
- EP 1/2" NPT-M Pipe
- DP 1/2" NPT-F Pipe
- XX Other, Please Specify

Gaskets

- S Spirometallic
- P Metal-Plastic
- K Fiber + NBR
- X Other, please specify

Flange Schedule

010	10
10S	10S
020	20
030	30
STD	STD
40S	40S
040	40
060	60
0XS	XS
80S	80S
080	80
XX	Other, Please Specify
XD	If DIN please specify thickness in mm

Flange Size

ANSI		DIN	
B	3"	DN 65	O
C	4"	DN 100	P
D	6"	DN 150	Q
E	8"	DN 200	R
F	10"	DN 250	S
G	12"	DN 300	T
X	Other, Please Specify		

Options

Please Specify 2 characters code as located in options table (pag 12)
For example: HT, DY

- HT Hydrostatic Test
- DY Dye Penetrants Test

Documentation

Please Specify 1 character code as located in doc. table (pag 13)
For example: A, D, J

- A Calculation data sheet
- H Balance Chamber
- J Material Certificate EN 10204-3.1

Flanges Material

- A05 A-105
- F05 A-182 F5
- 304 A-182 F304/L
- 316 A-182 F316/L
- 904 A-182 F904L
- HAS Hastelloy
- MON Monel
- TIT Titanium
- XX Other, Please Specify

Flange Facing

- RF - C Raised Face RF
- FF - O Flat Face
- XX Other, please specify

Flange Rating

ANSI		DIN	
A	150#	G	PN 16
B	300#	H	PN 25
C	600#	I	PN 40
		X	Other, please specify

Flange Type

- W Welding Neck
- S Socket Welding
- X Other, please specify

Please specify here your X or XX selected: