

SELF CONTAINED LED EMERGENCY
Model: OPR (ORBIT PRO ROUND)



Self contained 3W LED emergency. Non maintained, self-test function. Includes interchangeable lenses for open area and corridor. Designed in a round shape and elegant line for surface and recessed mounting. Easy installation. It has a two coloured LED signaling integrated in the equipment.

Characteristics:

Model	OPR-2501 AT	OPR-2503 AT
Supply	230V~ 50/60Hz (220-240VAC)	
Functioning	Non maintained	
Power	3W	
Input current	<0,08A	
Check	Self-test	
Lumens	250 lm	
Autonomy	1 hour	3 hours
Battery	LiFePO4 6,4V-600mAh	LiFePO4 6,4V-1500mAh
Battery charging	24 hours	
LED	SAMSUNG 3535	
Colour temperature (CCT)	5000K	
Lense (2 types included)	Open (for open area) and corridor (for evacuation routes)	
Output voltage (LED)	2,8 -3,2VDC	
Output current (LED)	600mA	
Protection class	Class II	
Grade IP	IP40	
Circuit protections	Short-circuit / Overloading / Overtemperature	
Wrapping material	White colour PC	
Mounting	Ceiling surface and recessed mounting	
Operating temperature	0 - 45°C	
Ambient temperature	0 - 65°C	
Wight	0,37Kg	0,5Kg
CE marked	According standards 2014/35/UE and 2014/30/UE of EMC	
Manufactured	According standard UNE-EN 60598-2-22	

Dimensions:

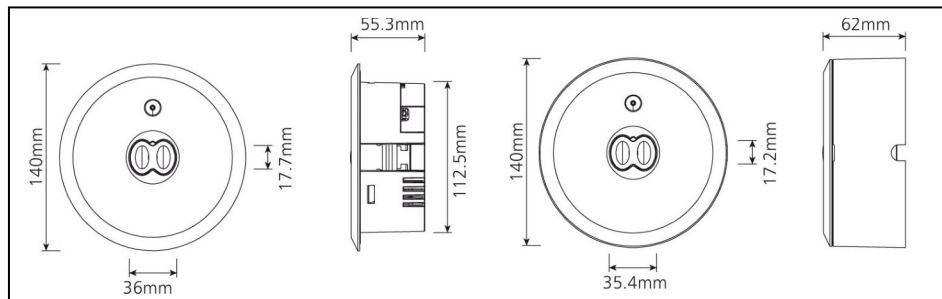

Self-test:

Once the equipment is connected, a self-test is automatically initiated in this way:

- Every 4 sec.: verifies battery disconnection and voltage, charger failure, lamp failure and AC / DC converter fault.
- Every month runs a 3 min. test of duration.
- Every year it runs a test of 1 hour or 3 hours depending on the model.

Signaling:

Two coloured LED indicator:

GREEN fixed light: Operation OK

RED blinking: Failure, according to the following signaling:

- | | | |
|-------|--------------------------------|-------------------------|
| * | 1 blinking and pause of 4 seg. | Battery not connected |
| ** | 2 blinking and pause of 4 seg. | Low battery voltage |
| *** | 3 blinking and pause of 4 seg. | Battery charger failure |
| **** | 4 blinking and pause of 4 seg. | AC/DC converter failure |
| ***** | 5 blinking and pause of 4 seg. | LED lamp failure |

Manual test:

- | | |
|---|--|
| Press the test button once | 30 sec. test of duration |
| Press the test button twice in 2 sec. | 3 min. test of duration |
| Press the test button three times in 2 sec. | 30 min. test of duration |
| Press the test button four times in 2 sec. | 1 hour or 3 hour test depending on the model |

Surface installation:

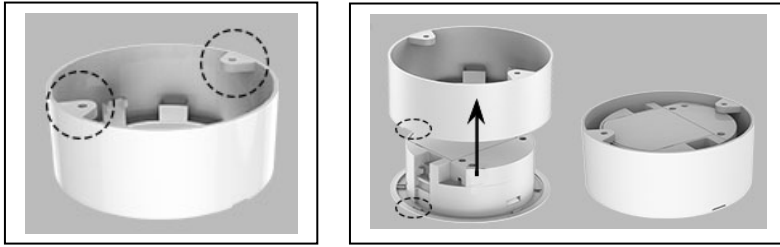

- 1.- Mount the surface mount accessory on the ceiling using 2 screws.
- 2.- Remove the mains cable from inside the accessory and connect the device to the L and N terminal strip (230VAC).
- 3.- Insert the equipment into the accessory, line up the marks until the anchor clip is triggered.
- 4.- Give the equipment a mains voltage and check that the indicator LED lights up in green.

Recessed installation:

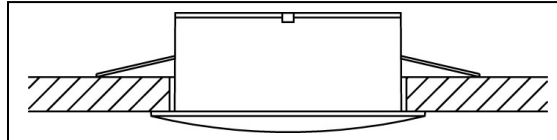
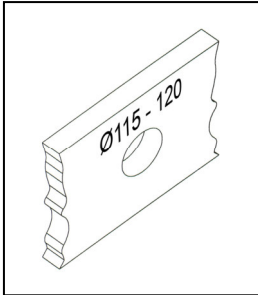

- 1.- Make a hole in the ceiling with a diameter of **115-120mm**
- 2.- Remove the network cable from the installation through the hole and connect the device to the L and N terminal strip (230VAC)
- 3.- Insert the equipment into the hole of the false ceiling with the springs facing up.
- 4.- Give the equipment a mains voltage and check that the indicator LED lights up in Green.

Spring assembly

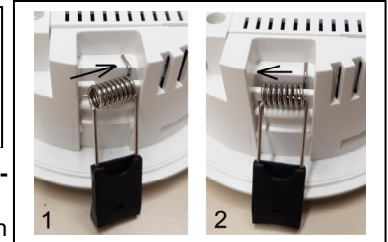

Maintenance:

The manipulation and the installation of the device should be done by qualified technicians. Always verify that the voltage of the mains is adequate to the input voltage of the device. Before installation make sure the mains is off. The LiFePO4 battery must be replaced when the equipment's autonomy time is less than 1 hour or 3 hours depending the model. It is convenient to write down the date of the change. The old battery should be recycled in a proper way, as it can be harmful for the environment.

Table of distances of open area ROUND LENSE
Minimum 0.5 lux on the evacuation route

Altura de montaje (m)		
2.50	5.8	11.6
3.00	6.2	12.4
4.00	6.6	13.2
5.00	6.6	13.2

Table of distances of the evacuation route CORRIDOR LENSE
Minimum 1 lux on the evacuation route

Mounting height (m)		
2.50	8.8	17.6
3.00	9.2	18.4
4.00	9	18
5.00	8	16

Cambio de lente:

