

# Serie ESCAPE LED

---



## **Installation**

Ceiling recessed.

## **Design**

White polycarbonate body with aluminium dissipator.

## **Optical part**

LED lenses for optimal lighting with a large opening angle.

# Serie ESCAPE LED

# IP20

Emergency lighting

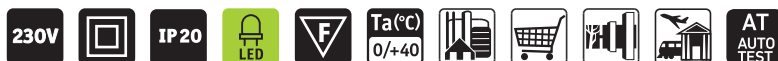

## TECHNICAL CHARACTERISTICS

- Supply 230V~ 50/60Hz.
- Input current: 40mA (maintained mode).
- Maintained / Non Maintained.
- Green Led indicating, the Battery charging.
- Output voltage: 3VDC.
- Output current: 600mA (Constant control).
- Output power: 1,8W.
- Protection against overloading and end of battery discharge.
- Round LED lamp plastic white material, with aluminium dissipator and fixing springs for false ceiling hole. White LED brand CREE high luminosity and long duration.
- Color Temperature: 6000K.
- Lumens: 150Lm.
- Autonomy more than 1 or 3 hours depending on model.
- Protection Grade IP20-IK04.
- Class II Luminary.
- Ambient temperature: 0-50°C.
- Verification test and standby-restart via Telemando (ref: TM).
- Stand by and re-start via Telemando (ref: TM).
- Battery charging 24 hours.
- Max cross section of cable to be connected 1,5mm.
- Recessed mounting.

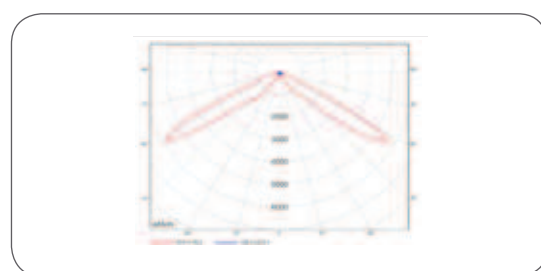

### CONNECTION SCHEME MAINTAINED WITH OFF AND ON LED DL LAMP



### CONNECTION SCHEME NON MAINTAINED



## APPLIED NORMS

- CE as per directives 2006/95/CE and 2004/108/CE.
- Manufactured as per norm UNE-EN 60598-2-22.

### DIMENSIONS

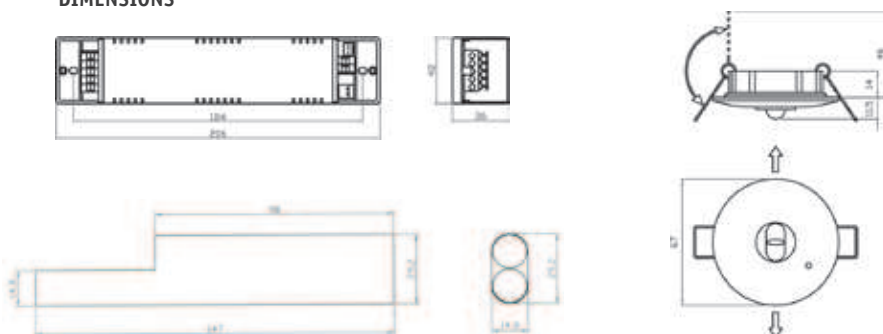

\* The arrows indicate the direction of maximum opening of the light through the lens.

# LED

## MAINTAINED / ON - OFF





IP20

Model	IP	Weight	Autonomy	Lumens	Battery	Lamp	Code
ESCAPE LED-1	20	0.38	1	150	6.0V 0.8Ah	1x3W	38501
ESCAPE LED-3	20	0.40	3	150	6.0V 2.5Ah	1x3W	38503

## AUTO TEST

IP20

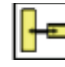
Model	IP	Weight	Autonomy	Lumens	Battery	Lamp	Code
ESCAPE LED-1 AT	20	0.38	1	150	6.0V 0.8Ah	1x3W	38504

Mouting height (m)					
2.00	4.49	10.95	9.34	4.60	2.14
2.50	5.36	13.08	11.07	5.65	2.59
3.00	6.15	15.03	12.62	5.18	1.34
3.50	6.87	16.76	14.23	5.52	1.14
4.00	7.85	18.47	15.91	4.13	0.78